



BE IT RESOLVED, by the Council of the City of Urbana, Illinois

that the following described street(s) be improved under the Illinois Highway Code:

Table with 4 columns: Name of Thoroughfare, Route, At, and a blank column. Rows include Green Street, Lincoln Avenue, and Killarney Street.

BE IT FURTHER RESOLVED,

- 1. That the proposed improvement shall consist of modernizing traffic signals at Green & Goodwin. Installing new traffic signals at Lincoln & Killarney.

and shall be constructed feet wide and be designated as Section 95-00000-02-TS

- 2. That there is hereby appropriated the (additional) sum of \$170,000 Dollars for the improvement of said section from the municipality's allotment of Motor Fuel Tax funds.

- 3. That work shall be done by Contract; and, (Specify Contract or Day Labor)

BE IT FURTHER RESOLVED, that the Clerk is hereby directed to transmit two certified copies of this resolution to the district office of the Department of Transportation.

APPROVED Department of Transportation District Engineer

Mr. Phyllis D. Clark City Clerk in and for the City of Urbana County of Champaign, hereby certify the foregoing to be a true, perfect and complete copy of a resolution adopted by the Urbana City Council at a meeting on 15th day of May 1995

IN TESTIMONY WHEREOF, I have hereunto set my hand and seal this 15th day of May, A.D. 1995

Tod Satterthwaite (SEAL) Mayor

Phyllis D. Clark City Clerk

Illinois Department of Transportation  <b>ESTIMATE OF COST</b>	Municipality: Urbana Road Dist.: County: Champaign Section: 95-00000-02-TS
--	---

Location (Sta. and land description of beginning; Sta. only for end for county and road district; street limits for municipality.)  
 Two Intersections: Green Street and Goodwin Avenue, and Lincoln Avenue and Kilmerney Street; both are located in the City of Urbana.

Traffic Signal Modernization is Intent of Project at both intersections.

a total distance of \_\_\_\_\_ feet, of which \_\_\_\_\_ feet (\_\_\_\_\_ miles) are to be improved. Station \_\_\_\_\_ is approximately \_\_\_\_\_ miles by road from the \_\_\_\_\_ railroad siding at \_\_\_\_\_.  
 Type \_\_\_\_\_ Width \_\_\_\_\_ Thickness \_\_\_\_\_ Shoulders \_\_\_\_\_  
 Average Length of Haul \_\_\_\_\_

Item No.	Items	Unit	Quantity	Unit Price	Total
1	Sig Head Poly 1F 3S MAM	EACH	10.0	\$450.00	\$4,500.00
2	Sig Head Poly 1F 5S MAM	EACH	6.0	\$605.00	\$3,630.00
3	Sig Head Poly 2F 1-3S 1-5S Bracket	EACH	6.0	\$930.00	\$5,580.00
4	Sig Head Poly 1F 3S Bracket	EACH	2.0	\$800.00	\$1,600.00
5	Ped Sig Head Poly 1F Bracket	EACH	4.0	\$550.00	\$2,200.00
6	Ped Sig Head Poly 2F Bracket	EACH	5.0	\$670.00	\$3,350.00
7	Traf Sig Backplate	EACH	16.0	\$80.00	\$1,280.00
8	Traf Sig Post A 12	EACH	1.0	\$400.00	\$400.00
9	Traf Sig Post A 13	EACH	4.0	\$410.00	\$1,640.00
10	Traf Sig Post A 14	EACH	1.0	\$420.00	\$420.00
11	Traf Sig Post A 15	EACH	2.0	\$430.00	\$860.00
12	Steel Mast Arm Asmbly & Post 32 Ft.	EACH	4.0	\$2,000.00	\$8,000.00
13	Steel Mast Arm Asmbly & Post 34 Ft.	EACH	4.0	\$2,400.00	\$9,600.00
14	Ful-Act Cont Stand Seq 4 8 Phase Ty 4 Cab	EACH	2.0	\$6,500.00	\$13,000.00
15	Induction Loop Detector Amplifier	EACH	14.0	\$100.00	\$1,400.00
16	Detector Loop, Ty 1	LF	966.0	\$7.00	\$6,762.00
17	Ped Pushbutton	EACH	14.0	\$130.00	\$1,820.00
18	Galv. Steel Conduit Trench 1 1/2"	LF	1,354.0	\$5.00	\$6,770.00
19	Galv. Steel Conduit Trench 2"	LF	4.0	\$8.50	\$34.00
20	Galv. Steel Conduit Trench 2 1/2"	LF	16.0	\$9.00	\$144.00
21	Galv. Steel Conduit Trench 3"	LF	18.0	\$9.50	\$171.00
22	Galv. Steel Conduit Trench 4"	LF	42.0	\$10.00	\$420.00
23	Galv. Steel Conduit Trench 5"	LF	12.0	\$20.00	\$240.00
24	Galv. Steel Conduit Pushed 2 1/2"	LF	76.0	\$20.00	\$1,520.00
25	Galv. Steel Conduit Pushed 3"	LF	76.0	\$22.00	\$1,672.00
26	Galv. Steel Conduit Pushed 4"	LF	75.0	\$35.00	\$2,625.00
27	Elec Cable in Conduit #14 2/C	LF	250.0	\$0.50	\$125.00
28	Elec Cable in Conduit #14 3/C	LF	1,114.0	\$0.60	\$668.40
29	Elec Cable in Conduit #14 5/C	LF	4,255.0	\$0.75	\$3,191.25
30	Elec Cable in Conduit #14 7/C	LF	665.0	\$0.85	\$565.25
31	Elec Cable in Conduit #14 3/C TW SH	LF	1,357.0	\$0.80	\$1,085.60
32	Elec Cable in Conduit #18 3 PR TW SH	LF	1,544.0	\$0.91	\$1,405.04
33	Elec Cable in Conduit #14 7/C TW SH	LF	933.0	\$0.90	\$839.70
34	Concrete Foundation Ty D	LF	7.0	\$265.00	\$1,855.00
35	Concrete Foundation Ty E 30" Dia	LF	88.0	\$90.00	\$7,920.00
36	Concrete Handhole	EACH	4.0	\$950.00	\$3,800.00
37	Concrete Heavy-Duty Handhole	EACH	2.0	\$1,500.00	\$3,000.00
38	Concrete Double Handhole	EACH	1.0	\$1,500.00	\$1,500.00
39	Gulfbox Junction	EACH	4.0	\$300.00	\$1,200.00
40	Trench & Backfill	LF	1,438.0	\$2.50	\$3,595.00
41	Remove Exist Traf Sig Equip	EACH	1.0	\$1,000.00	\$1,000.00
42	Remove Exist Conc Foundation	EACH	6.0	\$450.00	\$2,700.00
43	Light Detector	EACH	4.0	\$750.00	\$3,000.00
44	Light Detector Amplifier	EACH	4.0	\$2,000.00	\$8,000.00
45	Microwave Detector	EACH	4.0	\$300.00	\$1,200.00
46	Thermoplastic Pvmt Markings Ltr & Sym	SF	170.8	\$3.25	\$555.10
47	Thermoplastic Pvmt Marking Line 4"	LF	960.0	\$0.75	\$720.00
48	Thermoplastic Pvmt Marking Line 6"	LF	810.0	\$1.00	\$810.00
49	Thermoplastic Pvmt Marking Line 24"	LF	201.0	\$2.25	\$452.25

PAGE SUBTOTAL \$128,825.59

Made by: BHB Date: 5/10/95  
 Checked by: JLS Date: 5/10/95

Illinois Department of Transportation  <b>ESTIMATE OF COST</b>	Municipality: Urbana Road Dist.: County: Champaign Section: 95-00000-02-TS
--	---

Location (Sta. and land description of beginning; Sta. only for end for county and road district; street limits for municipality.)  
 Two Intersections: Green Street and Goodwin Avenue, and Lincoln Avenue and Klarney Street; both are located in the City of Urbana.  
 Traffic Signal Modernization is Intent of Project at both intersections.

a total distance of \_\_\_\_\_ feet, of which \_\_\_\_\_ feet (\_\_\_\_\_ miles) are to be improved. Station \_\_\_\_\_ is approximately \_\_\_\_\_ miles by road from the \_\_\_\_\_ railroad siding at \_\_\_\_\_.  
 Type \_\_\_\_\_ Width \_\_\_\_\_ Thickness \_\_\_\_\_ Shoulders \_\_\_\_\_  
 Average Length of Haul \_\_\_\_\_

Item No.	Items	Unit	Quantity	Unit Price	Total
50	PCC Base Course 8"	SY	16.0	\$30.00	\$480.00
51	Bit Conc Surf Course D CI I Ty 2	TON	265.0	\$45.00	\$11,925.00
52	Bit Materials Prime Coat	GAL	306.0	\$2.50	\$765.00
53	Aggregate Prime Coat	TON	4.0	\$4.00	\$16.00
54	Concrete Curb Ty B	LF	38.0	\$18.00	\$684.00
55	Bit Surf Rem (Cold Milling) 1 1/2"	SY	3,064.0	\$3.00	\$9,192.00
56	Curb Removal	LF	78.0	\$3.00	\$234.00
57	Sidewalk Removal	SF	124.0	\$1.00	\$124.00
58	Median Removal (Special)	SF	144.0	\$3.00	\$432.00
59	PC Concrete Sidewalk 5"	SF	124.0	\$2.50	\$310.00
60	Temp Pavement Markings	LF	96.0	\$2.00	\$192.00
61	Traffic Control & Protection U-2	LS	1.0	\$2,000.00	\$2,000.00
62	Traffic Control & Protection U-4	LS	1.0	\$1,000.00	\$1,000.00
63					
64					
SUBTOTAL PAGE 1					\$128,825.59

TOTAL ESTIMATED COST \$156,179.59

Made by: BHB Date: 5/10/95  
 Checked by: JLS Date: 5/10/95

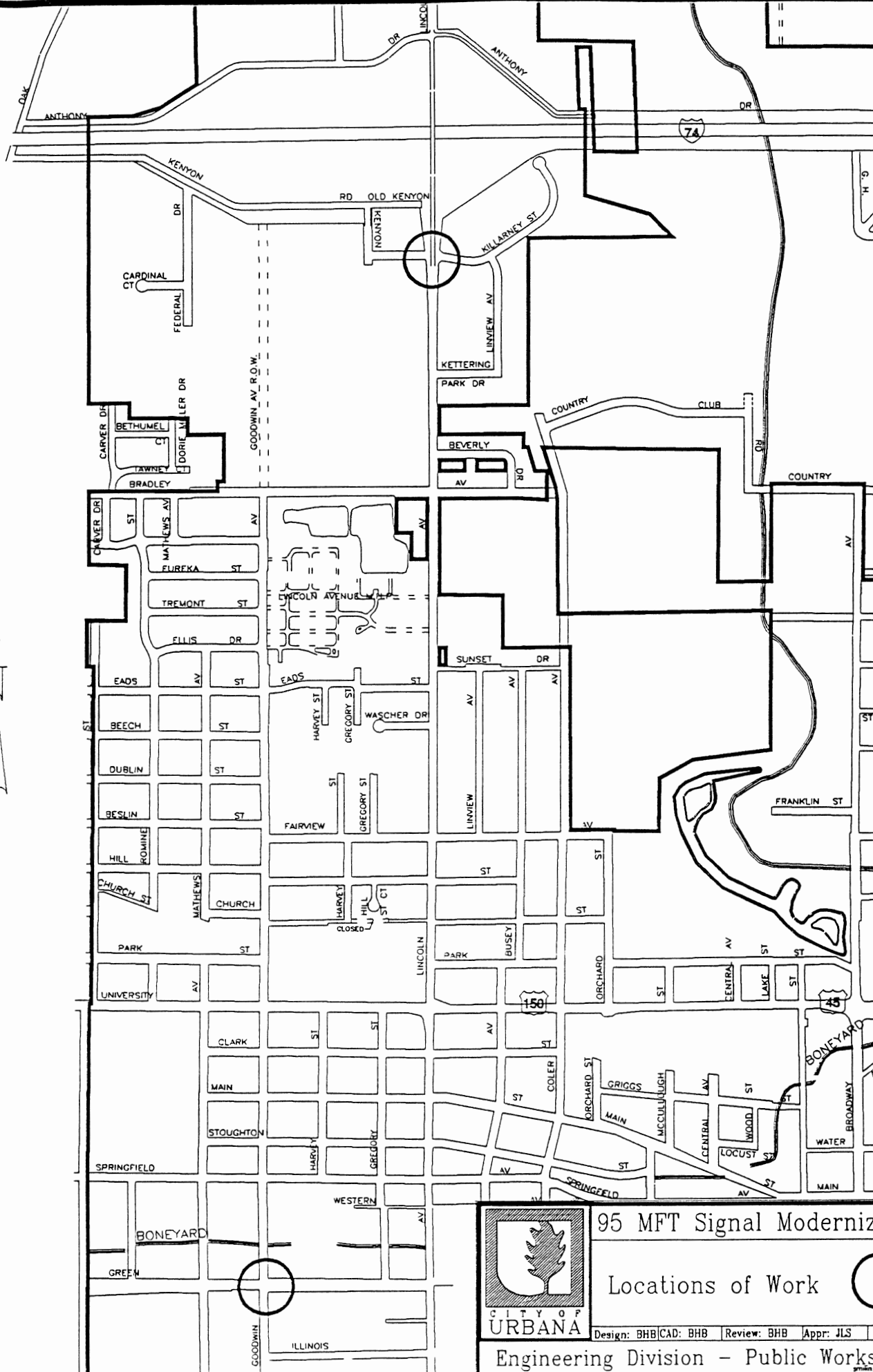

95 MFT Signal Modernization

Locations of Work

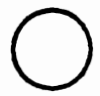

Design: BHB/CAD: BHB Review: BHB Appr: JLS 5/11/95

Engineering Division - Public Works Dept.