

A RESOLUTION
APPROVING AND AUTHORIZING THE EXECUTION OF
AN AGREEMENT FOR INSTALLATION OF A SANITARY
SEWER ON CARLE AVENUE FROM PENNSYLVANIA TO MICHIGAN

BE IT RESOLVED BY THE CITY COUNCIL OF THE CITY OF
URBANA, ILLINOIS, as follows:

1. That an Agreement between the City of Urbana,
Illinois and Kenneth L. Rinehart, Marlyn W. Rinehart, Daniel
Alpert, Natalie Alpert, Raymond Satterfield, and Ruth G.
Satterfield, a copy of which said Agreement is attached hereto
and incorporated by reference, be and the same is hereby
approved.

2. That the Mayor of the City of Urbana, Illinois,
be and the same is hereby authorized to execute said Agreement
for and on behalf of the City of Urbana, Illinois.

PASSED by the City Council this 5th day of
April, 1982.

Ruth S. Brookens
Ruth S. Brookens, City Clerk

APPROVED by the Mayor this 12th day of April,
1982.

Jeffrey T. Markland
Jeffrey T. Markland, Mayor

THIS IS THE ATTACHMENT WHICH IS REFERRED TO IN
RESOLUTION NO. 8182-R39 AND IS INCORPORATED
THEREIN BY REFERENCE.

Ruth S. Brookens
Ruth S. Brookens, City Clerk

April 12, 1982
Date

AGREEMENT FOR INSTALLATION OF A SANITARY SEWER
ON CARLE AVENUE FROM PENNSYLVANIA TO MICHIGAN

THIS AGREEMENT entered into as of the 24th day of March, 1982, between the City of Urbana, Illinois, hereinafter referred to as "The City", and Kenneth L. Rinehart, Marlyn W. Rinehart; Daniel Alpert, Natalie Alpert; Raymond Satterfield and Ruth G. Satterfield; hereinafter referred to as "Residents".

WHEREAS, The City has adopted an ordinance for the construction of Local Improvement #189 - Carle Park Sewer Project; and

WHEREAS, the Residents named herein reside within the Carle Park Sewer Project area; and own the lots described as follows:

- a. Lot 8 of Block 8 of Hubbard Terrace Subdivision to the City of Urbana; and
- b. Lot 1 and the east 15' of Lot 2 of Block 7 of Hubbard Terrace Subdivision to the City of Urbana; and
- c. Lot 14 of Block 7 of Hubbard Terrace Subdivision to the City of Urbana, and

WHEREAS, the Residents and The City agree it is in the interest of the Residents to modify the proposed plan for construction of the sewer project which shall service said residents' homes.

NOW, THEREFORE, it is agreed between the parties as follows:

1. That The City shall construct a sanitary sewer line from Pennsylvania Avenue northward onto Carle Avenue substantially

located in accordance with the attached drawing marked Exhibit "A".

2. That The City agrees to construct said sanitary sewer line substantially in accordance with those materials indicated on the attached Exhibit "B".

3. That The City agrees to locate the said sewer and sewer trench no farther west than as shown on Exhibit "A" in order to avoid destroying a portion of the lawn and landscaping located on Daniel and Natalie Alpert's property and on The City's Carle Avenue right of way.

4. That the Residents agree to pay to The City in addition to their individual assessment amount of \$1,557.00 per residence, any additional cost to The City to install the sewer line on Carle Avenue which shall service the lots described herein. Said additional amount to be paid shall be calculated by determining the difference between what it would have cost The City as of the date of construction to construct the sewer line to service said Residents' homes according to the original plans dated September 22, 1981 and what the cost is to actually install the sewer line on Carle Avenue. The Residents agree that they shall pay said additional amount in accordance with the following percentages:

- | | |
|---|-------|
| a. Kenneth L. Rinehart & Marlyn Rinehart
Lot 8 of Block 8 of Hubbard Terrace Sub-
division to the City of Urbana | 42.5% |
| b. Raymond Satterfield & Ruth G. Satterfield
Lot 1 and the East 15' of Lot 2 of Block 7
of Hubbard Terrace Subdivision to the City of
Urbana | 42.5% |
| c. Daniel Alpert & Natalie Alpert
Lot 14 of Block 7 of Hubbard Terrace Sub-
division to the City of Urbana | 15.0% |

In the event the cost or any part of the cost of said construction is paid from funds other than those of The City, said Residents shall be credited with such payments and their additional payment to The City shall be correspondingly reduced.

5. The additional amount to be paid shall be due within thirty (30) days of notification of completion and acceptance by The City of the work on Carle Avenue. Said payment shall be made in cash payable to The City of Urbana.

6. This agreement shall be binding upon the parties, their heirs, administrators, executors, and assigns; and shall be recorded at the Champaign County Recorder's Office at the Residents' expense.

Executed the day and year first above written.

THE CITY OF URBANA, ILLINOIS

By _____

ATTESTED TO BY:

- RESIDENTS -

Kenneth L. Rinehart Jr.
Kenneth L. Rinehart

Marilyn Rinehart
Marilyn Rinehart

Daniel Alpert
Daniel Alpert

Natalie Alpert
Natalie Alpert

Raymond Satterfield

Raymond Satterfield

Ruth G. Satterfield

Ruth G. Satterfield

Subscribed and sworn to before me this

24th day of March, 1982.

George J. Eijuney
Notary Public

My Commission Expires 10/17/84

March 3, 1982

<u>DESCRIPTION</u>	<u>QUANTITY</u>	<u>UNIT PRICE</u>	<u>COST</u>
Granular Trench Backfill	120 Cubic Yards	\$ 10.65	\$ 1,278.00
Portland Cement Concrete Curb and Gutter Removal	38 Lineal Feet	2.50	95.00
Portland Cement Concrete Curb and Gutter Placement	38 Lineal Feet	12.00	456.00
Portland Cement Concrete Sidewalk Removal	200 Square Feet	.50	100.00
Portland Cement Concrete Sidewalk Placement (4 inch thickness)	200 Square Feet	3.14	628.00
Portland Cement Concrete Pavement Removal	50 Square Yards	6.87	343.50
Brick Pavement Removal and Replacement	0 Square Feet	.	0.00
Portland Cement Concrete Base Course (8 inch thickness)	0 Square Yards		0.00
Portland Cement Concrete Surface Course (8 inch thickness)	50 Square Yards	19.43	971.50
Portland Cement Concrete Surface Course (6 inch thickness)	12 Square Yards	22.03	264.36
CRS-2 Prime Coat	0 Gallons		0.00
Bituminous Concrete Surface Course - Hand Method (1 1/2 inch thickness)	0 Square Yards		0.00

<u>DESCRIPTION</u>	<u>QUANTITY</u>	<u>UNIT PRICE</u>	<u>COST</u>
3. Temporary Surface Over Trench	14 Cubic Yards	\$ 18.40	\$ 257.60
4. Seeding and Fertilizing	2500 Square Feet	.07	175.00
5. Sodding	0 Square Feet		0.00
6. Existing Fence Removal and Replacement	0 Lineal Feet		0.00
7. Extra Strength Vitrified Clay Pipe (6 inch diameter)	120 Lineal Feet	12.60	1,512.00
8. Extra Strength Vitrified Clay Pipe 30° Long Radius Bends (6 inch diameter)	4 Each	30.00	120.00
9. Connection to Existing 8-inch Sanitary Sewer	0 Each		0.00
10. Connection to Existing 10-inch Sanitary Sewer	0 Each		0.00
11. 6-inch diameter Plugs	4 Each	6.00	24.00
22. 8-inch Extra Vitrified Clay Pipe (8 to 10 feet)	250 Lineal Feet	25.00	6,250.00
23. 48 inch Diameter Manhole	1 Each	1,120.00	1,120.00
24. Additional Depth of Manhole	2.5 Vertical Feet	70.00	175.00
		TOTAL	\$13,745.90

DANIEL AND NATALIE ALPERT

Proposed M.H.
Station 2 + 50
Rim Elevation-739.26
Inv. 8" S-727.50
Inv. 6" W-727.67

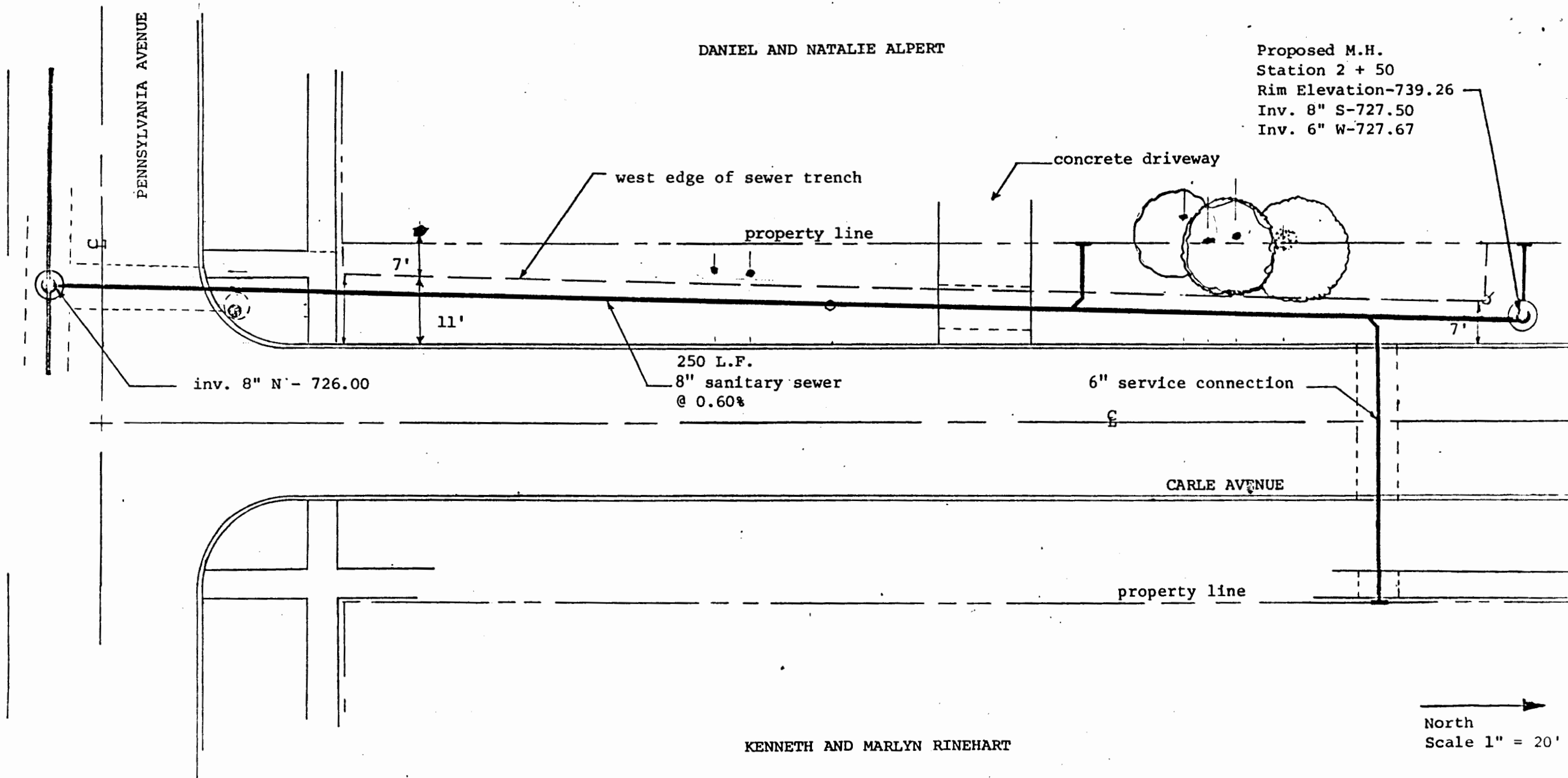

KENNETH AND MARLYN RINEHART

EXHIBIT "A"