

ORDINANCE NO. 8384- 10

AN ORDINANCE
FOR THE LEVY AND ASSESSMENT OF TAXES FOR THE FISCAL
YEAR BEGINNING JULY 1, 1983 AND ENDING JUNE 30, 1984, IN
AND FOR THE CITY OF URBANA SPECIAL SERVICE AREA NUMBER TWO

BE IT ORDAINED BY THE CITY COUNCIL OF THE CITY OF
URBANA, ILLINOIS, as follows:

Section 1. Findings. The City of Urbana Special Service Area Number Two has been created by an Ordinance, entitled, "An Ordinance Establishing City of Urbana Special Service Area Number Two," adopted September 7, 1976, approved September 8, 1976, and effective as of September 8, 1976, and no petition had been filed opposing the creation of the special service area pursuant to Chapter 120, Illinois Revised Statutes, Section 1309. Said Special Service Area Number Two consists of the territory described in the Ordinance aforesaid, which such territory is also more particularly described in Attachment "A" to this Ordinance and depicted on Attachment "B" of this Ordinance. The City of Urbana is now authorized to levy taxes for special services in said Special Service Area Number Two.

Section 2. That the total amount of budgeted appropriations for all purposes to be collected from the tax levy of the current fiscal year in Special Service Area Number Two is ascertained to be the sum of \$16,400.00.

Section 3. That the following sum be, and the same hereby is, levied upon the taxable property, as defined in the Revenue Act of 1939, in the City of Urbana Special Service Area Number Two, said tax to be levied for the fiscal year beginning July 1, 1983 and ending June 30, 1984:

	<u>Budget</u> <u>Appro-</u> <u>priations</u>	<u>To Be</u> <u>Raised By</u> <u>Tax Levy</u>
<u>GENERAL CORPORATE FUND</u>		
Special Service Area Number Two		
Reimbursement to Motor Fuel Tax	\$ 16,400	\$16,400
Fund		

Section 4. That the sum of \$15,000.00 of the \$16,400.00 sum heretofore authorized to be levied under this Ordinance for the fiscal year beginning July 1, 1983 and ending June 30, 1984, is further ascertained to be the sum and amount attributable to the following specific portion of the taxable property, as defined in the Revenue Act of 1939, in Special

Service Area Number Two, which such taxable property consists of the following described territory and is depicted and listed in Attachment "C" to this Ordinance:

The South 360 feet of the West 390 feet of the Southeast Quarter of Section 16, Township 19 North, Range 9 East of the Third Principal Meridian, Champaign County, Illinois; and all real estate located South of the South line of said Section 16, Township 19 North, Range 9 East of the Third Principal Meridian, Champaign County, Illinois, except the North 190 feet of the East 190 feet of the Northeast Quarter of the Northwest Quarter of Section 21, Township 19 North, Range 9 East of the Third Principal Meridian, Champaign County, Illinois;

and that said sum of \$15,000.00 be and the same is hereby abated for the fiscal year beginning July 1, 1983 and ending June 30, 1984, the City of Urbana having previously received payment from the property owners of such specific portion of the taxable property as defined in the Revenue Act of 1939 in Special Service Area Number Two in accordance with an agreement between the City of Urbana and such property owners dated the 9th day of April, 1979, which such agreement was approved by the Circuit Court, Champaign County, Illinois, in Docket Numbers 76-C-1045 and 77-C-156. The County Clerk of Champaign County, Illinois is accordingly directed to extend no taxes for collection on the tax books for the purpose of raising revenues to pay appropriations in Special Service Area Number Two for the fiscal year beginning July 1, 1983 and ending June 30, 1984, upon such specific portion of the taxable property more particularly described in this section, and as defined in the Revenue Act of 1939, in Special Service Area Number Two.

Section 5. That the sum of \$1,400.00 of the \$16,400.00 sum heretofore authorized to be levied under this Ordinance for the fiscal year beginning July 1, 1983 and ending June 30, 1984, is further ascertained to be the sum and amount attributable to the rest and remainder of the taxable property, as defined in the Revenue Act of 1939 and not otherwise described in Section 4 of this Ordinance but which is further depicted and listed on Attachment "C" in Special Service Area Number Two for the fiscal year beginning July 1, 1983 and ending June 30, 1984.

Section 6. This tax is levied pursuant to Article VII, Sections 6A and 6L of the Constitution of the State of Illinois and Chapter 120, Illinois Revised Statutes, Section 1301 et seq. and pursuant to An Ordinance Establishing the City of Urbana Special Service Area Number Two.

Section 7. That there is hereby certified to the County Clerk of Champaign County, Illinois, the sum of \$1,400.00 constituting the total amount of tax the City of Urbana Special Service Area Number Two requires to be raised by taxation for the current fiscal year of said City, said sum of \$1,400.00 to be levied upon the rest and remainder of the taxable property, as defined in the Revenue Act of 1939 and not otherwise described in Section 4 of this Ordinance but which is further depicted and listed on Attachment "C" hereto, in City of Urbana Special Service Area Number Two for which no abatement is herein provided, and the City Clerk of the City of Urbana is hereby ordered and directed to file with the County Clerk of Champaign County, Illinois, on or before the time required by law a certified copy of this Ordinance.

Section 8. This Ordinance shall be in full force and effect from and after its adoption, approval and publication as provided by law.

This Ordinance is hereby passed by the affirmative vote, the "ayes" and "nays" being called, of a majority of the members of the Council of the City of Urbana, Illinois, at a regular meeting of said Council.

PASSED by the City Council this 6th day of September, 1983.

Ruth S. Brookens
Ruth S. Brookens, City Clerk

APPROVED by the Mayor this 9th day of September, 1983.

Jeffrey T. Markland
Jeffrey T. Markland, Mayor

FILED

SEP 9 1983

Dennis R. Berg
COUNTY CLERK

THIS IS THE ATTACHMENT WHICH IS REFERRED TO IN
ORDINANCE NO. 8384-10 AND IS INCORPORATED
THEREIN BY REFERENCE.

Ruth S. Brookens
Ruth S. Brookens, City Clerk

September 8, 1983
Date

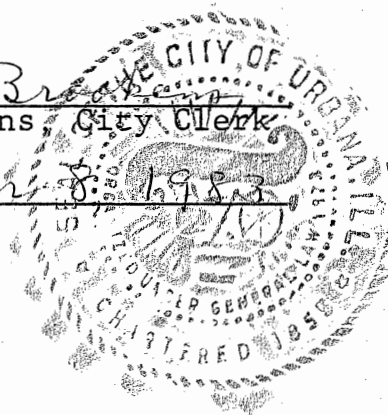

SPECIAL SERVICE AREA NUMBER TWO
ATTACHMENT "A"

Beginning at the Northwest corner of Lot 75 of Fairlawn Park Sixth Addition in Section 16, Township 19 North, Range 9 East of the Third Principal Meridian; thence Southerly along the east right-of-way line of Cottage Grove Avenue across Florida Avenue to a point 412 feet south of the North line of Section 21; thence easterly along a line parallel to the North line of the Northwest Quarter of Section 21 to a point 600 feet west of the east line of the Northwest Quarter of Section 21; thence southerly along a line parallel to the east line of the Northwest Quarter of Section 21 to a point 677.35 feet south of the north line of the Northwest Quarter of Section 21; thence easterly along a line parallel to the north line of the Northwest Quarter of Section 21 to the east line of the Northwest Quarter of Section 21; thence along the west line of the Northeast Quarter of Section 21 to a point 660 feet from the Southwest corner of the Northwest Quarter of the Northeast Quarter of Section 21; thence easterly along a line parallel to the southline of the Northeast Quarter of Section 21 to a point 520 feet west of the east line of the Northwest Quarter of the Northeast Quarter of Section 21; thence northerly to the Southwest corner of the east 520 feet of the north 480 feet of the Northwest Quarter of the Northeast Quarter of Section 21; thence easterly along a line parallel to the north line of the Northeast Quarter of Section 21 to the southeast corner of the north 480 feet of the Northwest Quarter of the Northeast Quarter of Section 21; thence northerly along the east line of the Northwest Quarter of the Northeast Quarter of Section 21 to the south right-of-way line of Florida Avenue; thence easterly along the south right-of-way of Florida Avenue to the point of intersection with the eastern line extended of Lot 4 of Weller's Lincolnwood Manor; thence northerly along the eastern line extended of said Lot 4 to the Southeast corner of said Lot 4; thence northerly along the eastern line of said Lot 4 to the northeast corner of said Lot 4; thence westerly along the northern lines of Lots 4 and 1 of Weller's Lincolnwood Manor, to the northwest corner of said Lot 1; thence southerly along the western line extended of said Lot 1 to the southeast corner of Lot 12, Block 17 of Champaign-Urbana Amvets Subdivision; thence westerly along the southern line of Champaign-Urbana Amvets Subdivision to the southwest corner of Lot 5, Block 16 of Champaign-Urbana Amvets Subdivision; thence northerly along the western line of Block 16 of Champaign-Urbana Amvets Subdivision to the northwest corner of Lot 1 of said Block 16; thence westerly along the southern line extended of Block 15 of Champaign-Urbana Amvets Subdivision to a point on the east right-of-way line of Philo Road; thence southerly along the east right-of-way line of Philo Road to the point of intersection with the Northern line extended of Lot 88 of Fairlawn Park Sixth Addition; thence westerly along the northern line extended of Lot 88 of Fairlawn Park Sixth Addition to the northwest corner of Lot 88; thence westerly along the northern lines of Lots 89, 90, 91, 92, 93, 94, 95, 96, 97 and 98 of Fairlawn Park Sixth Addition to the northwest corner of said Lot 98; thence southerly along the western line of said Lot 98 to the point of intersection with the northern line extended of Lot 67 of Fairlawn Park Sixth Addition; thence westerly along the northern line extended of said Lot 67 to the northwest corner of said Lot 67; thence westerly along the northern lines of Lots 68, 69, 70, 71, 72, 73, and 75 of Fairlawn Park Sixth Addition to the northwest corner of said Lot 75, said corner of Lot 75 being the point of beginning.

All located in Sections 16 and 21 of Township 19 North, Range 9 East of the Third Principal Meridian, Champaign County, Illinois.

SPECIAL SERVICE AREA NUMBER TWO
ATTACHMENT "C"

Page 2

LIST OF TAXABLE PROPERTY DEPICTED IN
SHADED AREA ON PAGE 1 OF THIS ATTACHMENT
"C" UPON WHICH \$15,000 OF THE TOTAL LEVIED
TAX OF \$16,400 IS ABATED PURSUANT TO
SECTION 4 OF THIS ORDINANCE:

<u>Parcel</u>	<u>Permanent Tax Number</u>
22	93-21-16-453-008
23	93-21-21-200-010
24	93-21-21-200-025
25	93-21-21-200-016
26	93-21-21-200-017
27	93-21-21-126-005
28	93-21-21-126-019
30	93-21-21-126-011
31 & 32	93-21-21-126-018
33	93-21-21-126-002
	93-21-21-126-020
34	93-21-21-126-021
	93-21-21-126-022

LIST OF TAXABLE PROPERTY DEPICTED IN
UNSHADED AREA ON PAGE 1 OF THIS ATTACHMENT
"C" UPON WHICH \$1,400 OF THE TOTAL LEVIED
TAX OF \$16,400 IS TO BE EXTENDED FOR
COLLECTION PURSUANT TO SECTIONS 5 AND 7
OF THIS ORDINANCE:

<u>Parcel</u>	<u>Permanent Tax Number</u>
1	93-21-16-381-003
2	93-21-16-381-010
3	93-21-16-381-011
4	93-21-16-381-012
5	93-21-16-381-013
6	93-21-16-381-014
7	93-21-16-381-015
8	93-21-16-381-018
9	93-21-16-382-005
10	93-21-16-382-015
11	93-21-16-382-016
12	93-21-16-382-017
13	93-21-16-382-018
14	93-21-16-382-019
15	93-21-16-382-020
16	93-21-16-382-021
17	93-21-16-382-022
18	93-21-16-382-023
19	93-21-16-382-026
20	93-21-16-461-015
21	93-21-16-461-016
29	93-21-21-126-004

SPECIAL SERVICE AREA NUMBER TWO - ATTACHMENT "B"

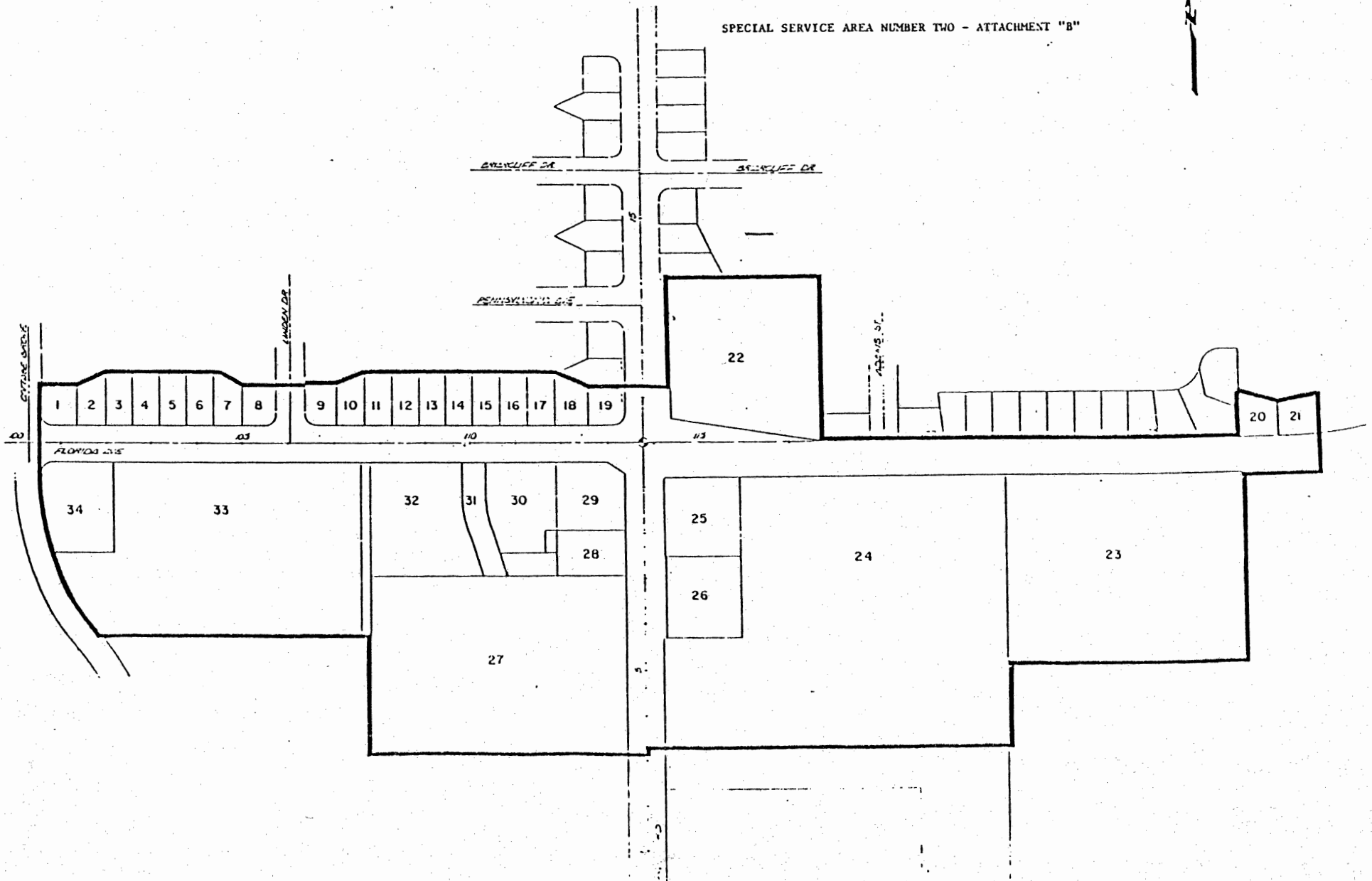

NOTE:

-Shaded area is specific portion of taxable property of Special Service Area Number Two specifically described in Section 4 of this Ordinance, which such taxable property is further listed on page 2 of this Attachment "C".

-Unshaded area is rest and remainder of taxable property of Special Service Area Number Two referred to in Sections 5 and 7 of this Ordinance, which such taxable property is further listed on page 2 of this Attachment "C".

