

ORDINANCE ANNEXING CERTAIN TERRITORY
TO THE CITY OF URBANA

WHEREAS, a resolution describing the real property set forth below was duly passed by the Urbana City Council on November 2, 1981, in which said resolution the Urbana City Council determined to contemplate the question of whether the property therein described should be annexed to the City of Urbana, Illinois, and directed the City Clerk to publish Notice that the annexation of the properties therein described would be considered by the Urbana City Council at its regular meeting on December 7, 1981, and

WHEREAS, the City Clerk of Urbana, Illinois duly published such Notice on November 24, 1981, in The News-Gazette, a newspaper having general circulation in the City of Urbana, Illinois, and the area proposed to be annexed, a Certificate of Publication therefor being on file with the City Clerk's Office, and

WHEREAS, the hereinafter described territory is situated in unincorporated territory adjacent to and contiguous to the City of Urbana, Illinois, and is part of the Edge-Scott Fire Protection District and includes certain Highways within the Urbana Township, and Notice was given to the Trustees of the said Fire Protection District, the Board of Township Trustees, and the Township Commissioner of Highways, said Notices being mailed on November 24, 1981, that this Ordinance would be voted upon at the regular meeting of this Council at 7:30 P.M., Monday, December 7, 1981, and the Affidavit of mailing such Notices was duly recorded with the Recorder of Deeds of Champaign County, Illinois on the 25th day of November, 1981, and

WHEREAS, the majority of the Members of the Council are of the opinion that it would be for the best interests of the People of the City of Urbana, Illinois, that said territory be annexed to and made a part of the said City,

THEREFORE, BE IT ORDAINED BY THE CITY COUNCIL OF THE CITY OF URBANA, ILLINOIS:

Section 1. That the Urbana City Council finds and determines that the property described below is surrounded by property previously annexed to the City of Urbana, Illinois, within the meaning of Section 7-1-1 of the Illinois Municipal Code.

Section 2. That the following described real estate, viz:

GROUP I

A. Lot 1018 in Country Squire Estates First Plat commonly known as 1905 East Rainbow View, Urbana, Illinois;
The above-described parcel, prior to annexation, has the permanent index number 30-21-16-431-007, and following annexation the said parcel shall bear the permanent index number 92-21-16-431-007.

B. Lot 1033 in Country Squire Estates First Plat commonly known as 1908 Country Squire Drive, Urbana, Illinois;
The above-described parcel, prior to annexation, has the permanent index number 30-21-16-431-025, and following annexation the said parcel shall bear the permanent index number 92-21-16-431-025.

C. Lot 1034 in Country Squire Estates First Plat commonly known as 1910 Country Squire Drive, Urbana, Illinois;
The above described parcel, prior to annexation, has the permanent index number 30-21-16-431-026, and following annexation the said parcel shall bear the permanent index number 92-21-16-431-026.

D. Lot 1035 in Country Squire Estates First Plat and the Street R.O.W. of Country Squire Drive from the West property line of Lot 1035 in Country Squire Estates First Plat to the East property line of Lot 1155 in Country Squire Estates Fourth Plat commonly known as 1913 County Squire Drive, Urbana, Illinois;
The above-described parcel, prior to annexation, has the permanent index number 30-21-16-432-030, and following annexation the said parcel shall bear the permanent index number 92-21-16-432-030.

E. Lot 1132 in Country Squire Estates Third Plat; also all of the sidewalk R.O.W. lying adjacent to said Lot 1132

commonly known as 2001 East Rainbow View, Urbana, Illinois;
The above-described parcel, prior to annexation, has the permanent index number 30-21-16-431-008, and following annexation the said parcel shall bear the permanent index number 92-21-16-431-008.

F. Lot 1133 in Country Squire Estates Third Plat commonly known as 2003 East Rainbow View, Urbana, Illinois;
The above-described parcel, prior to annexation, has the permanent index number 30-21-16-431-009, and following annexation the said parcel shall bear the permanent index number 92-21-16-431-009.

G. Lot 1134 in Country Squire Estates Third Plat commonly known as 2005 East Rainbow View, Urbana, Illinois;
The above-described parcel, prior to annexation, has the permanent index number 30-21-16-431-010, and following annexation the said parcel shall bear the permanent index number 92-21-16-431-010.

H. Lot 1135 in Country Squire Estates Third Plat commonly known as 2007 East Rainbow View, Urbana, Illinois;
The above-described parcel, prior to annexation, has the permanent index number 30-21-16-431-011, and following annexation the said parcel shall bear the permanent index number 92-21-16-431-011.

I. Lot 1136 in Country Squire Estates Third Plat commonly known as 2009 East Rainbow View, Urbana, Illinois;
The above-described parcel, prior to annexation, has the permanent index number 30-21-16-431-012, and following annexation the said parcel shall bear the permanent index number 92-21-16-431-012.

J. Lot 1144 in Country Squire Estates Third Plat commonly known as 2012 East Country Squire Drive, Urbana, Illinois;
The above-described parcel, prior to annexation, has the permanent index number 30-21-16-431-032, and following annexation the said parcel shall bear the permanent index number 92-21-16-431-032.

K. Lot 1145 in Country Squire Estates Fourth Plat commonly known as 2010 East Country Squire Drive, Urbana, Illinois;
The above-described parcel, prior to annexation, has the permanent index number 30-21-16-431-031, and following annexation the said parcel shall bear the permanent index number 92-21-16-431-031.

L. Lot 1146 in Country Squire Estates Fourth Plat commonly known as 2008 East Country Squire Drive, Urbana, Illinois;
The above-described parcel, prior to annexation, has the permanent index number 30-21-16-431-030, and following annexation the said parcel shall bear the permanent index number 92-21-16-431-030.

M. Lot 1147 in Country Squire Estates Fourth Plat commonly known as 2006 East Country Squire Drive, Urbana, Illinois;
The above-described parcel, prior to annexation, has the permanent index number 30-21-16-431-029, and following annexation the said parcel shall bear the permanent index number 92-21-16-431-029.

N. Lot 1148 in Country Squire Estates Fourth Plat commonly known as 2004 East Country Squire Drive, Urbana, Illinois; The above-described parcel, prior to annexation, has the permanent index number 30-21-16-431-028, and following annexation the said parcel shall bear the permanent index number 92-21-16-431-028.

O. Lot 1149 in Country Squire Estates Fourth Plat; also all of the sidewalk R.O.W. lying adjacent to said Lot 1149 commonly known as 2002 East Country Squire Drive, Urbana, Illinois; The above-described parcel, prior to annexation, has the permanent index number 30-21-16-431-027, and following annexation the said parcel shall bear the permanent index number 92-21-16-431-027.

P. Lot 1150 in Country Squire Estates Fourth Plat; also all of the sidewalk R.O.W. lying adjacent to said Lot 1150 commonly known as 2001 East Country Squire Drive, Urbana, Illinois; The above-described parcel, prior to annexation, has the permanent index number 30-21-16-432-031, and following annexation the said parcel shall bear the permanent index number 92-21-16-432-031.

Q. Lot 1151 in Country Squire Estates Fourth Plat commonly known as 2003 East Country Squire Drive, Urbana, Illinois; The above-described parcel, prior to annexation, has the permanent index number 30-21-16-432-032, and following annexation the said parcel shall bear the permanent index number 92-21-16-432-032.

R. Lot 1152 in Country Squire Estates Fourth Plat commonly known as 2005 East Country Squire Drive, Urbana, Illinois; The above-described parcel, prior to annexation, has the permanent index number 30-21-16-432-033, and following annexation the said parcel shall bear the permanent index number 92-21-16-432-033.

S. Lot 1154 in Country Squire Estates Fourth Plat commonly known as 2009 East Country Squire Drive, Urbana, Illinois; The above-described parcel, prior to annexation, has the permanent index number 30-21-16-432-035, and following annexation the said parcel shall bear the permanent index number 92-21-16-432-035.

T. Lot 1155 in Country Squire Estates Fourth Plat commonly known as 2011 East Country Squire Drive, Urbana, Illinois; The above-described parcel, prior to annexation, has the permanent index number 30-21-16-432-036, and following annexation the said parcel shall bear the permanent index number 92-21-16-432-036.

all being situated in the Southeast Quarter of Section 16, Township 19 North, Range 9 East of the Third Principal Meridian, Champaign County, Illinois.

GROUP II

A. Lot 1012 in Country Squire Estates First Plat; also all of the sidewalk R.O.W. lying between said Lots 1012 and 1119 commonly known as 1905 East Weaver Street, Urbana, Illinois;

The above-described parcel, prior to annexation, has the permanent index number 30-21-16-430-003, and following annexation the said parcel shall bear the permanent index number 92-21-16-430-003.

B. Lot 1119 in Country Squire Estates Third Plat; also all of the sidewalk R.O.W. lying between said Lots 1012 and 1119 commonly known as 1907 East Weaver Street, Urbana, Illinois; The above-described parcel, prior to annexation, has the permanent index number 30-21-16-430-005, and following annexation the said parcel shall bear the permanent index number 92-21-16-430-005.

C. Lot 1120 in Country Squire Estates Third Plat commonly known as 1909 East Weaver Street, Urbana, Illinois; The above-described parcel, prior to annexation, has the permanent index number 30-21-16-430-006, and following annexation the said parcel shall bear the permanent index number 92-21-16-430-006.

D. Lot 1121 in Country Squire Estates Third Plat commonly known as 1911 East Weaver Street, Urbana, Illinois; The above-described parcel, prior to annexation, has the permanent index number 30-21-16-430-007, and following annexation the said parcel shall bear the permanent index number 92-21-16-430-007.

E. Lot 1124 in Country Squire Estates Third Plat commonly known as 2003 East Weaver Street, Urbana, Illinois; The above-described parcel, prior to annexation, has the permanent index number 30-21-16-430-010, and following annexation the said parcel shall bear the permanent index number 92-21-16-430-010.

F. Lot 1125 in Country Squire Estates Third Plat commonly known as 2005 East Weaver Street, Urbana, Illinois; The above-described parcel, prior to annexation, has the permanent index number 30-21-16-430-022, and following annexation the said parcel shall bear the permanent index number 92-21-16-430-022.

G. Lot 1126 in Country Squire Estates Third Plat commonly known as 2006 East Rainbow View, Urbana, Illinois; The above-described parcel, prior to annexation, has the permanent index number 30-21-16-430-021, and following annexation the said parcel shall bear the permanent index number 92-21-16-430-021.

H. Lot 1127 in Country Squire Estates Third Plat commonly known as 2004 East Rainbow View, Urbana, Illinois; The above-described parcel, prior to annexation, has the permanent index number 30-21-16-430-020, and following annexation the said parcel shall bear the permanent index number 92-21-16-430-020.

I. Lot 1128 in Country Squire Estates Third Plat commonly known as 2002 East Rainbow View, Urbana, Illinois; The above-described parcel, prior to annexation, has the permanent index number 30-21-16-430-019, and following annexation the said parcel shall bear the permanent index number 92-21-16-430-019.

- J. Lot 1129 in Country Squire Estates Third Plat commonly known as 5 Rainbow Court, Urbana, Illinois;

The above-described parcel, prior to annexation, has the permanent index number 30-21-16-430-018, and following annexation the said parcel shall bear the permanent index number 92-21-16-430-018.

- K. Lot 1130 in Country Squire Estates Third Plat commonly known as 4 Rainbow Court, Urbana, Illinois;

The above-described parcel, prior to annexation, has the permanent index number 30-21-16-430-017, and following annexation the said parcel shall bear the permanent index number 92-21-16-430-017.

all being situated in the Southeast Quarter of Section 16, Township 19 North, Range 9 East of the Third Principal Meridian, Champaign County, Illinois.

GROUP III

- A. Lot 1093 in Country Squire Estates Fourth Plat commonly known as 2005 East Easy Street, Urbana, Illinois;

The above-described parcel, prior to annexation, has the permanent index number 30-21-16-429-009, and following annexation the said parcel shall bear the permanent index number 92-21-16-429-009.

- B. Lot 1095 in Country Squire Estates Fourth Plat commonly known as 2009 East Easy Street, Urbana, Illinois;

The above-described parcel, prior to annexation, has the permanent index number 30-21-16-429-011, and following annexation the said parcel shall bear the permanent index number 92-21-16-429-011.

- C. Lot 1113 in Country Squire Estates Third Plat commonly known as 3 Weaver Place, Urbana, Illinois;

The above-described parcel, prior to annexation, has the permanent index number 30-21-16-429-020, and following annexation the said parcel shall bear the permanent index number 92-21-16-429-020.

- D. Lot 1112 in Country Squire Estates Third Plat commonly known as 4 Weaver Place, Urbana, Illinois;

The above-described parcel, prior to annexation, has the permanent index number 30-21-16-429-021, and following annexation the said parcel shall bear the permanent index number 92-21-16-429-021.

all being situated in the Southeast Quarter of Section 16, Township 19 North, Range 9 East of the Third Principal Meridian, Champaign County, Illinois.

be and the same are hereby annexed to the City of Urbana, Illinois.

Section 3. That the City Clerk be authorized and directed to file for record a certified copy of this Ordinance together with an accurate map of the territory hereinabove described in the Office of the Recorder of Deeds for Champaign County, Illinois.

Section 4. This Ordinance shall be in full force and effect from after its passage and recording as provided by law.

This Ordinance is hereby passed by the affirmative vote, the "ayes" and "nays" being called, of a majority of the members of the Council of the City of Urbana, Illinois, at a regular meeting of said Council on the 7th day of December, A.D. 1981.

PASSED by the City Council this 7th day of December, 1981.

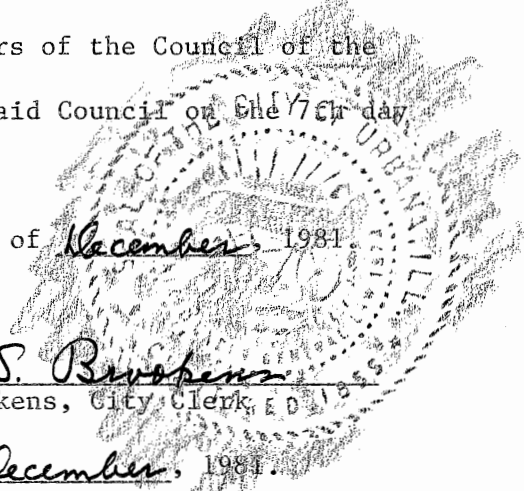
Ruth S. Brookens
Ruth S. Brookens, City Clerk

APPROVED by the Mayor this 9th day of December, 1981.

Jeffrey T. Markland
Jeffrey T. Markland, Mayor

CLERK'S CERTIFICATE

STATE OF ILLINOIS)
) SS
COUNTY OF CHAMPAIGN)

I, Ruth S. Brookens, City Clerk of the City of Urbana, Illinois, and keeper of the records, files and seal of said City, do hereby certify that the foregoing is a true and exact copy of an ordinance entitled, "Ordinance Annexing Certain Territory To The City Of Urbana" adopted by the City Council of the City of Urbana, Illinois on the 7th day of December, A.D. 1981, as appears in the records and files in my office remaining.

Given under my hand and seal of said City of Urbana, Illinois, this 5th day of January, A.D. 1982.

Ruth S. Brookens
Ruth S. Brookens, City Clerk

CITY OF URBANA, ILL.
RECEIVED

JAN 11 1982

CITY CLERK'S OFFICE

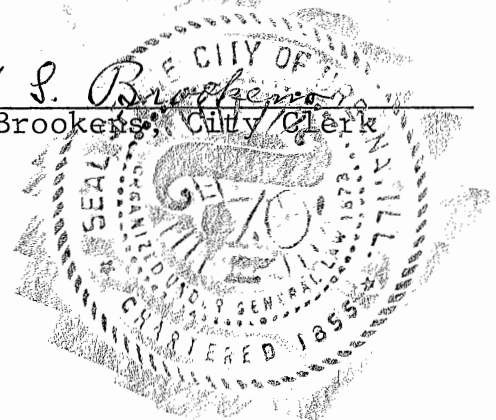

THIS IS THE ATTACHMENT WHICH IS REFERRED TO IN
ORDINANCE NO. 8182-41 AND IS INCORPORATED
THEREIN BY REFERENCE.

Ruth S. Brookens
Ruth S. Brookens, City Clerk

January 13, 1982
Date



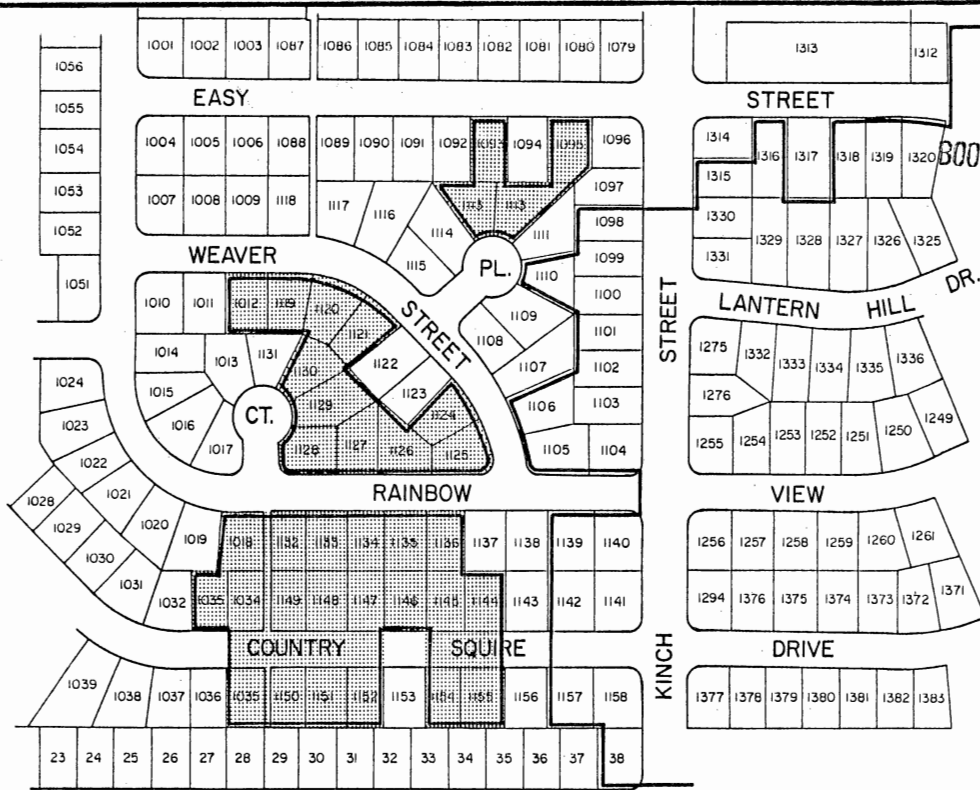



LEGAL DESCRIPTION

Lots 1012, 1018, 1033, 1034 and 1035 in Country Squires Estates First Plat; Lots 1112, 1113, 1119, 1120, 1121, 1124, 1125, 1126, 1127, 1128, 1129, 1130, 1132, 1133, 1134, 1135, 1136 and 1144 in Country Squires Estates Third Plat; Lots 1093, 1095, 1145, 1146, 1147, 1148, 1149, 1150, 1151, 1152, 1154 and 1155 in Country Squires Estates Fourth Plat; and the street R.O.W. of Country Squire Drive from the West property line of Lot 1035 in Country Squire Estates First Plat East to the East property line of Lot 1155 in Country Squire Estates Fourth Plat; Also all of the sidewalk R.O.W. lying adjacent to said Lots 1012, 1119, 1132, 1149 and 1150; All being situated in the Southeast Quarter of Section 16, Township 19, North, Range 9 East of the Third Principal Meridian, Champaign County, Illinois. Commonly known as: 1905 East Weaver Street, 1905 East Rainbow View, 1908, 1910, 1913 Country Squire Drive, 4, 3, Weaver Place, 1907, 1909, 1911, 2003, 2005 East Weaver Street, 2006, 2004, 2002 East Rainbow View, 5, 4 Rainbow Court, 2001, 2003, 2005, 2007, 2009 Rainbow View, 2012 East Country Squire Drive, 2005, 2009 East Easy Street, 2010, 2008, 2006, 2004, 2002, 2001, 2003, 2005, 2009, and 2011 East Country Squire Drive, respectively.

MAP SHOWING AREA ANNEXED
BY CITY ORDINANCE NO. 8182-41
CITY OF URBANA, ILLINOIS
CHAMPAIGN COUNTY
DATE: DECEMBER 7, 1981

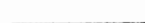
SCALE 1"=200'

 AREA OF ANNEXATION
 PRESENT CITY LIMITS
 NEW CITY LIMIT LINE

DRAWN BY: VAS CHECKED BY: RAF

CITY OF URBANA
ENGINEERING DEPARTMENT

Balbir S. Kindra.

CITY ENGINEER

82R 134

INDEXED

STATE OF ILLINOIS

CHAMPAIGN COUNTY

} SS

Filed for record in the Recorder's Office
of said county.

JAN 5 - 1982 - 1 30 PM

Recorded in Book

1280

of

Records

on Page

701

Robert C. Martin

Recorder of Deeds

City Clerk

City of Urbana

1200 PD