

ORDINANCE ANNEXING CERTAIN TERRITORY
TO THE CITY OF URBANA

WHEREAS, the hereinafter described territory is situated in unincorporated territory adjacent to and contiguous to the City of Urbana, Illinois, and is part of the Philo Fire Protection District, and Notice was given to the Trustees of the said Fire Protection District, said Notice being mailed on the 3rd day of June, 1977, that this Ordinance would be voted upon at the regular meeting of this Council at 7:30 P.M., Tuesday, July 5, 1977, and the Affidavit of mailing such notices was duly recorded with the Recorder of Deeds of Champaign County, Illinois, and

WHEREAS, a written Petition signed by all of the owners of Record and all electors residing therein, of all land within such territory, has been filed with the City Clerk of the City of Urbana, Illinois, requesting annexation thereof to the City of Urbana, and

WHEREAS, it has been determined that said Petition complies with all requirements of the law therefor, and

WHEREAS, the majority of the members of the Council are of the opinion that it would be for the best interests of the People of the City of Urbana, Illinois, that said territory be annexed to and made a part of the said City,

THEREFORE, BE IT ORDAINED BY THE CITY COUNCIL OF THE CITY OF URBANA, ILLINOIS,

Section 1. That the following described real estate, viz:

The West 1485.00 feet of the South 140.00 feet of the Southeast Quarter of Section 21, Township 19 North, Range 9 East, of the Third Principal Meridian, Champaign County, Illinois, and also all adjoining street right-of-way of Philo Road (Illinois Route 130) described as follows: commencing at a point 30.00 feet South and 76.25 feet East of the Southwest corner of the Southeast Quarter of Section 21, Township 19 North, Range 9 East of the Third Principal Meridian, for a point of beginning; thence Easterly along the existing Southern right-of-way line of Philo Road (Illinois Route 130), 1408.75 feet; thence Northerly, 60.00 feet; thence Easterly along the existing Northern right-of-way line of Philo Road (Illinois Route 130) to a point 30.00 feet North and 301.60 feet East of the Southwest corner of said Southeast Quarter, said described point being the point of curvature for a curve to the right, having a radius of 271.6 feet; thence Northwesterly along said curve to a point 140.00 feet North and 76.25 feet East of said Southwest corner of said Southeast Quarter; thence Southerly, 81.66 feet; thence Southeasterly along the Western right-of-way line of said curve of Philo Road (Illinois Route 130), to a point 30.00 feet North and 111.36 feet East of said Southwest corner; thence West, 35.11 feet; thence Southerly 60.00 feet to the point of beginning; said tract containing 5.58 acres more or less, all situated in Champaign County, Illinois.

be and the same is hereby annexed to the City of Urbana, Illinois.

Section 2. That the City Clerk be authorized and directed to file for record a certified copy of this Ordinance together with an accurate map of the territory hereinabove described in the Office of the Recorder of Deeds for Champaign County, Illinois.

Section 3. This Ordinance shall be in full force and effect from after its passage and recording as provided by law.

This Ordinance is hereby passed by the affirmative vote, the "ayes" and "nays" being called, of a majority of the members of the Council of the City of Urbana, Illinois, at a regular meeting of said Council on the 5th day of July, A.D., 1977.

PASSED by the City Council this 5th day of July, A.D., 1977.

Duane Eckerty
Duane Eckerty, City Clerk
Dorothy Umbarger
Dorothy Umbarger, Deputy Clerk

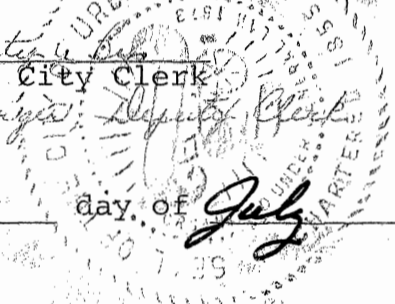

APPROVED by the Mayor this 7th day of July, 1977.

Jeffrey T. Markland
Jeffrey T. Markland, Mayor

③

WHEREAS, the hereinafter described territory is situated in unincorporated territory adjacent to and contiguous to the City of Urbana, Illinois, and is part of the Philo Fire Protection District, and Notice was given to the Trustees of the said Fire Protection District, said Notice being mailed on the 3rd day of June, 1977, that this Ordinance would be voted upon at the regular meeting of this Council at 7:30 P.M., Tuesday, July 5, 1977, and the Affidavit of mailing such notices was duly recorded with the Recorder of Deeds of Champaign County, Illinois, and

WHEREAS, a written Petition signed by all of the owners of Record and all electors residing therein, of all land within such territory has been filed with the City Clerk of the City of Urbana, Illinois, requesting annexation thereof to the City of Urbana, and

WHEREAS, it has been determined that said Petition complies with all requirements of the law therefor, and

WHEREAS, the majority of the members of the Council are of the opinion that it would be for the best interests of the People of the City of Urbana, Illinois, that said territory be annexed to and made a part of the said City,

THEREFORE, BE IT ORDAINED BY THE CITY COUNCIL OF THE CITY OF URBANA, ILLINOIS,

Section 1. That the following described real estate, viz:

The West 1485.00 feet of the South 140.00 feet of the Southeast Quarter of Section 21, Township 19 North, Range 9 East, of the Third Principal Meridian, Champaign County, Illinois, and also all adjoining street right-of-way of Philo Road (Illinois Route 130) described as follows: commencing at a point 30.00 feet South and 76.25 feet East of the Southwest corner of the Southeast Quarter of Section 21, Township 19 North, Range 9 East of the Third Principal Meridian, for a point of beginning; thence Easterly along the existing Southern right-of-way line of Philo Road (Illinois Route 130), 1408.75 feet; thence Northerly, 60.00 feet; thence Easterly along the existing Northern right-of-way line of Philo Road (Illinois Route 130) to a point 30.00 feet North and 301.60 feet East of the Southwest corner of said Southeast Quarter, said described point being the point of curvature for a curve to the right, having a radius of 271.6 feet; thence Northwesterly along said curve to a point 140.00 feet North and 76.25 feet East of said Southwest corner of said Southeast Quarter; thence Southerly, 81.66 feet; thence Southeasterly along the Western right-of-way line of said curve of Philo Road (Illinois Route 130), to a point 30.00 feet North and 111.36 feet East of said Southwest corner; thence West, 35.11 feet; thence Southerly 60.00 feet to the point of beginning; said tract containing 5.58 acres more or less, all situated in Champaign County, Illinois.

STATE OF ILLINOIS)
) SS.
COUNTY OF CHAMPAIGN)

I, DUANE ECKERTY, City Clerk of the City of Urbana, Illinois, and keeper of the records, files and seal of said City, do hereby certify that the foregoing is a true and exact copy of an ordinance entitled, "An Ordinance Annexing Certain Territory To The City Of Urbana", adopted by the City Council of the City of Urbana, Illinois, on the 5th day of July, A.D. 1977, as appears in the records and files in my office remaining.

Given under my hand and seal of said City of Urbana, Illinois, this 22nd day of July, A.D. 1977.

Duane Eckerty, By
Beverly Umberger, Deputy Clerk
CITY CLERK

No
(S E A L)

7778-4

THIS IS THE ATTACHMENT WHICH IS REFERRED TO IN
ORDINANCE NO. 7778-4 AND IS INCORPORATED
THEREIN BY REFERENCE.

Ruth S. Brookens, City Clerk

Date

1001	1002	1003	1004	1005	1006	1007	1008	1009	1010	1011	1012	1013	1014	1015	1016	1017	1018	1019	1020
43	42	41	40	39	38	37	36	35	34	33	32	31	30	29	28	27	26	25	24
1021	1022	1023	1024	1025	1026	1027	1028	1029	1030	1031	1032	1033	1034	1035	1036	1037	1038	1039	1040
43	42	41	40	39	38	37	36	35	34	33	32	31	30	29	28	27	26	25	24
1041	1042	1043	1044	1045	1046	1047	1048	1049	1050	1051	1052	1053	1054	1055	1056	1057	1058	1059	1060
43	42	41	40	39	38	37	36	35	34	33	32	31	30	29	28	27	26	25	24
1061	1062	1063	1064	1065	1066	1067	1068	1069	1070	1071	1072	1073	1074	1075	1076	1077	1078	1079	1080
43	42	41	40	39	38	37	36	35	34	33	32	31	30	29	28	27	26	25	24
1081	1082	1083	1084	1085	1086	1087	1088	1089	1090	1091	1092	1093	1094	1095	1096	1097	1098	1099	1100
43	42	41	40	39	38	37	36	35	34	33	32	31	30	29	28	27	26	25	24
1101	1102	1103	1104	1105	1106	1107	1108	1109	1110	1111	1112	1113	1114	1115	1116	1117	1118	1119	1120
43	42	41	40	39	38	37	36	35	34	33	32	31	30	29	28	27	26	25	24
1121	1122	1123	1124	1125	1126	1127	1128	1129	1130	1131	1132	1133	1134	1135	1136	1137	1138	1139	1140
43	42	41	40	39	38	37	36	35	34	33	32	31	30	29	28	27	26	25	24
1141	1142	1143	1144	1145	1146	1147	1148	1149	1150	1151	1152	1153	1154	1155	1156	1157	1158	1159	1160
43	42	41	40	39	38	37	36	35	34	33	32	31	30	29	28	27	26	25	24

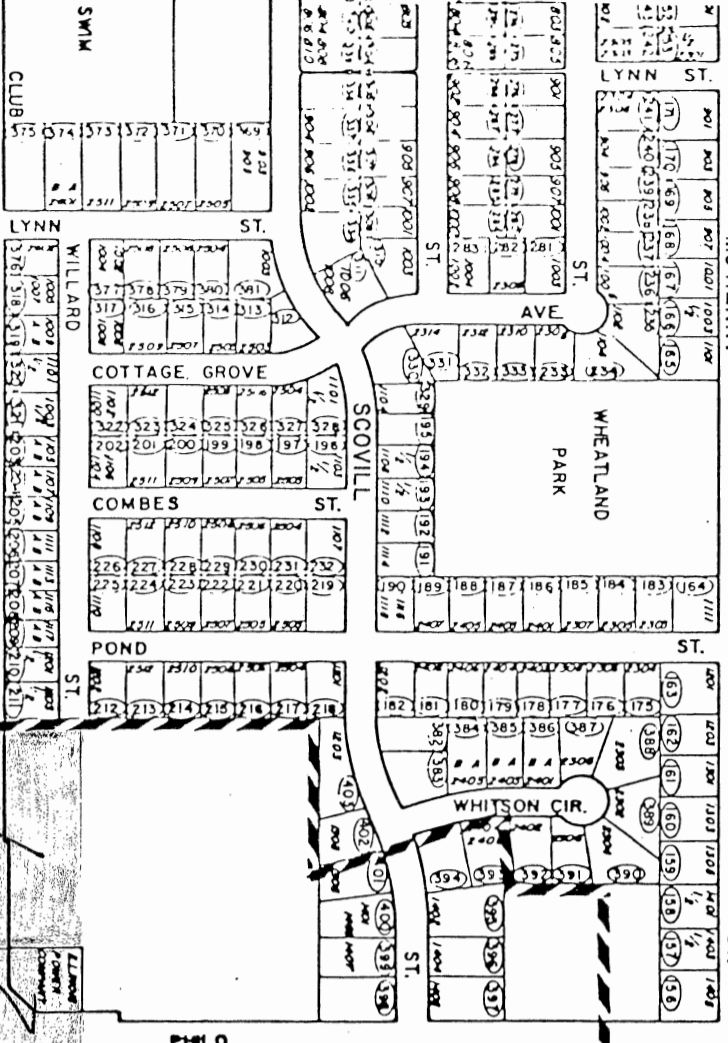

WINDSOR RD

