

AN ORDINANCE ANNEXING CERTAIN TERRITORY TO THE  
CITY OF URBANA, ILLINOIS

WHEREAS, it appears to the City Council of the City of Urbana, Illinois that a petition was filed with the City Clerk of the City of Urbana, Illinois on the 3d day of April, A.D. 1958, requesting the annexation of the territory hereinafter described, which said petition was signed under oath by all of the owners of record of real estate and ~~XXXXXX~~ <sup>there are no</sup> electors residing in said territory, and

WHEREAS, at least two-thirds of the aldermen are of the opinion that it would be for the best interests of the people of the City of Urbana, Illinois that said territory be annexed to, and made a part of the city limits of said City.

THEREFORE, BE IT ORDAINED BY THE CITY COUNCIL OF THE CITY OF URBANA, ILLINOIS:

SECTION 1. That the territory described as follows, to-wit:

Beginning 105 feet West of the Northwest corner of the NE $\frac{1}{4}$  of Section 16, Township 19 North, Range 9 East of the Third Principal Meridian, in Champaign County, Illinois, thence Southerly parallel to the West Line of the NE $\frac{1}{4}$  aforesaid 1446.47 feet, thence Easterly making an angle with the last line of 90 44', 670.2 feet, thence Westerly 670.2 feet to the point of beginning, situated in Champaign County, Illinois, and

Beginning at a point which is One Hundred Five (105) feet West of and One Thousand, Four Hundred Forty-six and forty-seven hundredths (1446.47) feet South of the Northwest corner of the Northeast Quarter (NE $\frac{1}{4}$ ) of Section Sixteen (16), Township Nineteen (19) North, Range Nine (9) East of the Third Principal Meridian, thence Southerly and parallel to the West line of said Northeast Quarter (NE $\frac{1}{4}$ ) a distance of One Thousand, One Hundred sixty eight and five hundredths (1168.05) feet, thence Easterly making an angle of Ninety degrees, Forty-five minutes (90 45') with the previous line a distance of Six Hundred Seventy and forty-five hundredths (670.45) feet, thence Northerly making an angle of Eighty-nine degrees, Twenty-seven minutes (89 27') with previous line a distance of One Thousand, One Hundred Sixty-six and five hundredths (1166.05) feet, thence Westerly making an angle of Ninety degrees, Forty-two minutes (90 42') with previous line a distance of Six Hundred Seventy and twenty Hundredths (670.20) feet to the point of beginning, situated in Champaign County, Illinois.

be, and the same is hereby annexed to, and shall hereafter be a part of the City of Urbana, Illinois, and that the corporate limits of said City be, and the same shall be changed so as to include said territory within the corporate limits of said City.

SECTION 2. The City Clerk of the City of Urbana, Illinois, shall record with the Recorder of Deeds of the County of Champaign, Illinois, a copy of this ordinance, together with an accurate map of the annexed territory.

Adopted by the City Council of the City of Urbana, Illinois, this 7th day of April, A. D. 195<sup>8</sup>.

Bess M. Holmes

CITY CLERK

Approved by the Mayor this 7th day of April, A. D. 195<sup>8</sup>.

Stanley B. Beaver

MAYOR

# ANNEXATION PLAT CITY OF URBANA, ILLINOIS

NORTH LINE SEC. 16-19-9

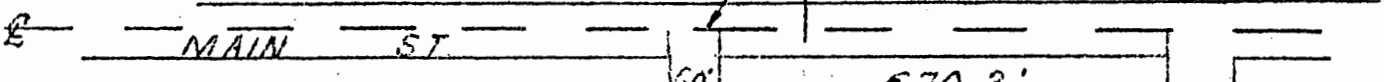

NORTH SOUTH Q SEC. 16.

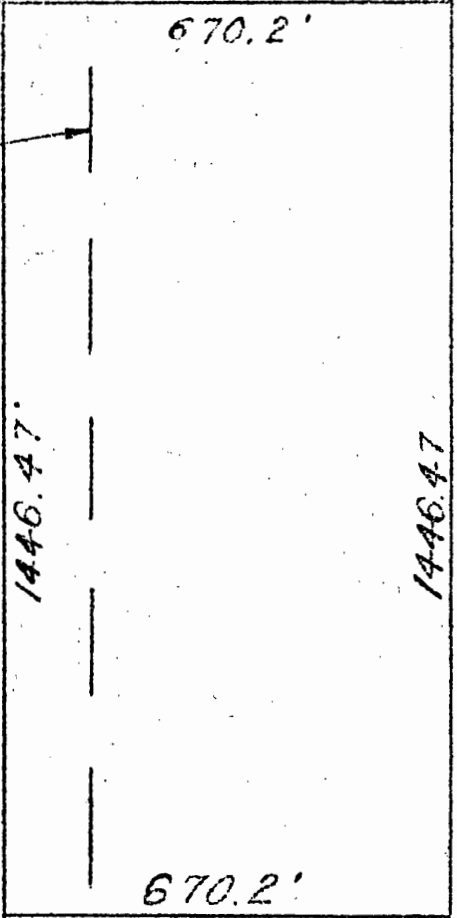

AVENUE



EAST WEST Q  
SEC. 16.

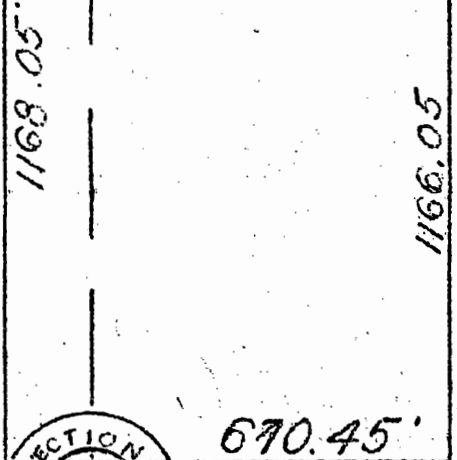

LIERMAN

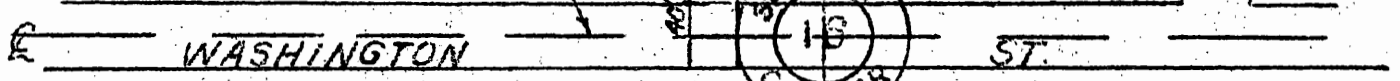

M. H. KINCH, E  
CITY ENGR.

APRIL 10, 1958  
SCALE: 1" = 300'