

AN ORDINANCE ANNEXING CERTAIN TERRITORY  
TO THE CITY OF URBANA, ILLINOIS

BE IT ORDAINED BY THE CITY COUNCIL OF THE CITY OF URBANA, ILLINOIS:

Section 1: The territory hereinafter described is owned by the City of Urbana and is contiguous, uninhabited, unincorporated territory located adjacent to the north boundary of the present City of Urbana.

Section 2: That it is for the best interests of the City of Urbana that said territory should be annexed to the City of Urbana.

Section 3: A map showing the location of said territory is hereto attached and made a part of this ordinance and the territory to be annexed is outlined in red on said map.

Section 4: That the following described real estate be and is hereby annexed to the City of Urbana:

Beginning at the Southwest corner of Lot Twenty-nine (29) of a subdivision of the Northeast Quarter (NE $\frac{1}{4}$ ) of Section Eight (8), Township Nineteen (19) North, Range Nine (9) East of the Third Principal Meridian and running thence North Three Hundred Ninety Six (396) feet thence East One Hundred Eighty (180) feet thence South Three Hundred Ninety Six (396) feet thence West One Hundred Eighty (180) feet to the place of beginning in Champaign County, Illinois.

Section 5. That a copy of this ordinance together with the map of the annexed territory shall be forwarded to the Recorder of Deeds of Champaign County, Illinois, for recording.

Section 6: This ordinance shall be effective as of the date of its passage.

Adopted by the City Council of Urbana, Illinois this 21st day of May, A. D. 1951.

Bess M. Holmes  
City Clerk

Approved by the Mayor this 26<sup>th</sup> day of May, A. D. 1951.

Glen E. Chapman

ANNEXATION PLAT

SHOWING THE AREA TO BE ANNEXED TO THE CITY OF URBANA, ILLINOIS, DESCRIBED AS FOLLOWS: BEGINNING AT THE SW CORNER OF THE SE 1/4 NE 1/4 OF SECTION 8 T 19 N R 9 E OF 3RD P.M.; THENCE NORTH ALONG THE WEST LINE OF SE 1/4 NE 1/4 SECT. 8-19-8 396 FEET; THENCE EASTERLY 180 FEET; THENCE SOUTHERLY 396 FEET; THENCE WESTERLY 180 FEET TO POINT OF BEGINNING ALL BEING IN CHAMPAIGN COUNTY, ILL. 180'

5-16-51

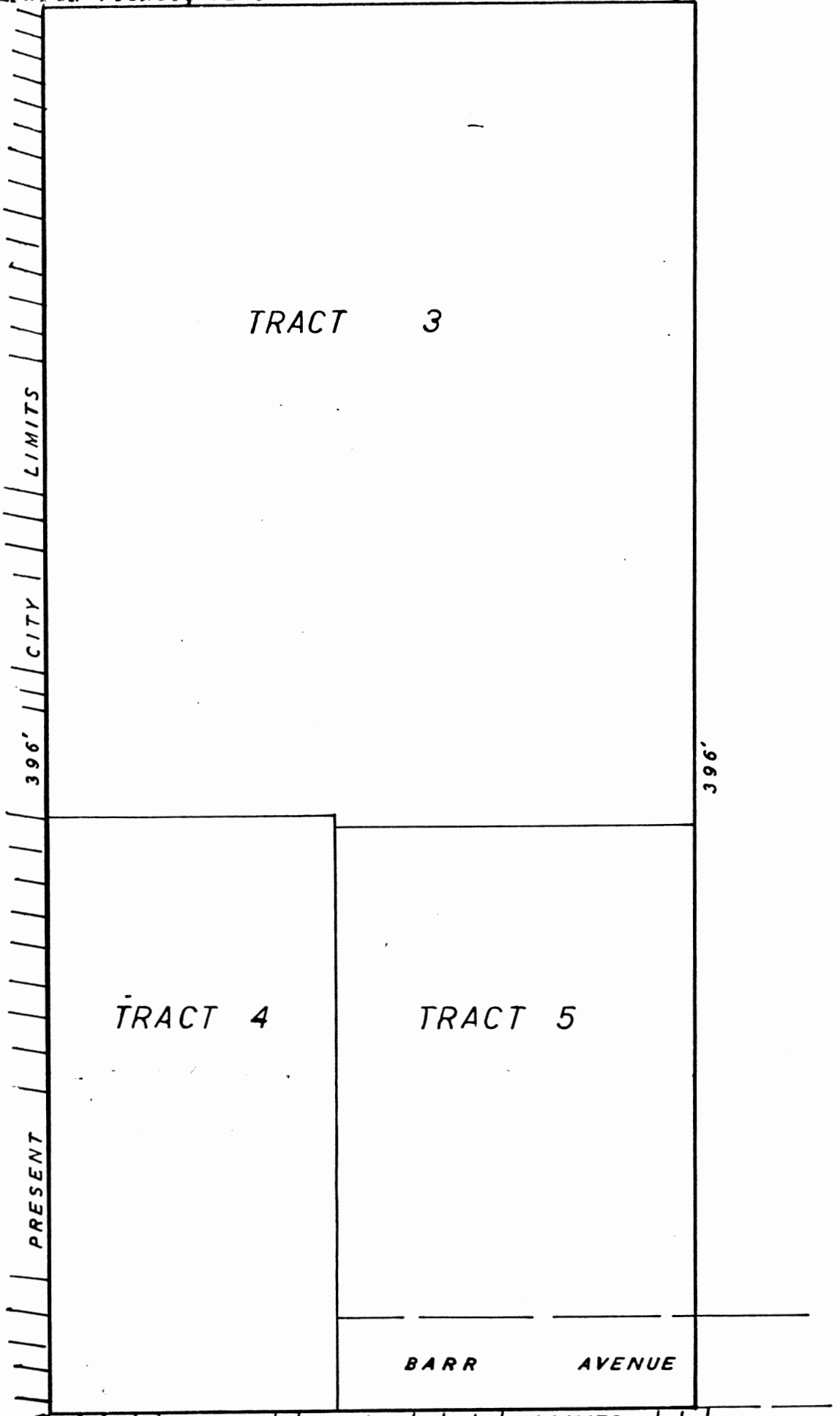

SCALE 1"=40'

SW COR. OF SE 1/4 NE 1/4 SECT. 8-19-9 BEING THE SW COR LOT 29 OF A SUB'N OF NE 1/4 SECT. 8-19-9

BY: M.H. KINCH, ENGINEER

5-16-51